

# AUX

## OPERATION MANUAL

---

### Split Type Air Conditioner

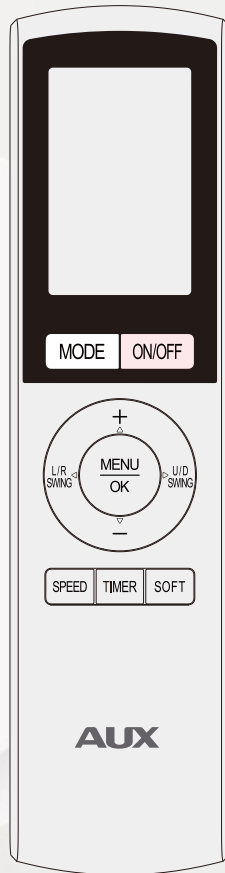

**Model:**  
C/121E

### CONTENTS

Safety Precautions .....	1
Preparation before Operation .....	2
Selecting Operation Modes .....	4
Fan Speed and Airflow Direction Adjustment .....	5
ON/OFF TIMER Operation .....	6
DISPLAY / SLEEP / I-FEEL / ICLEAN / HEALTH / ECO / ELE.H / ANTI-F Operation .....	7
Special Operation Functions .....	8
Care and Cleaning .....	9
Troubleshooting .....	10

- Please read this operation manual carefully and thoroughly before operating the unit.
- Take care of this manual for future reference.

# Safety Precautions

Incorrect installation or operation by not following these instructions may cause harm or damage to people, properties, etc. The seriousness is classified by the following indications:

 **WARNING**

This symbol indicates the possibility of death or serious injury.

 **CAUTION**

This symbol indicates the possibility of injury or damage to properties.

 Things you shouldn't do.  Follow the instructions.  Cut the power off.

 **WARNING** 

- **Don't** connect the ground wire to the gas pipeline, water pipeline, lightning rod, or telephone earth wire.
- **Don't** pull the power cable .Pulling the power cable could result in damage to the unit and electrical shock.
- **Don't** cut off main power switch during operating or with wet hands.It may cause electric shock.
- **Don't** share the socket with other electric appliance.Otherwise, it may cause electric shock even fire and explosion.
- **Don't** let the remote control and the indoor unit watered or being too wet. Exposure to excessive moisture may cause damage to the unit and or electrical shock.
- **Don't** install the air conditioner in a place where there is flammable gas or liquid unless the distance is equal to or greater than 1m apart.
- **Don't** use any unapproved liquid or cleaning agent to clean the air conditioner.
- **Don't** attempt to repair the air conditioner by yourself. Incorrect repairs may cause fire or explosion. Contact a qualified service technician for all service requirement.
- **Don't** operate the air conditioner during a lightning storm.The power should be switched off to prevent danger or injury.
- **Don't** put hands or any objects into the air inlets or outlets.This may cause personal injury or damage to the unit.
- **Don't** block air inlet or air outlet.Otherwise, the cooling or heating capacity will be diminished, or cause the system to stop operating.
- **This** appliance is not intended for use by persons (including children) with reduced physical, sensory or mental capabilities, or lack of experience and knowledge, unless they have been given supervision or instruction concerning use of the appliance by a person responsible for their safety. Children should be supervised to ensure that they do not play with the appliance.

 **WARNING** 

- **Please** mount the system on a secure surface to prevent the unit from falling and causing injury or damage.
- **The** appliance shall be installed in accordance with national and local wiring codes, i.e. a circuit breaker.

 **WARNING** 

- **Always** switch off the device and cut the power supply when the unit is not in use for long time so as to ensure safety..
- **Always** switch off the device and cut the power supply before performing any maintenance or cleaning. Otherwise, it may cause electric shock or damage.

 **CAUTION** 

- **Don't** operate the system with windows or doors open.Doing so will limit the system effectiveness.
- **Don't** stand on the top of the outdoor unit or place heavy objects on it. This could cause personal injuries or damage to the unit.
- **Don't** use the system for other purposes, such as drying clothes, preserving foods, etc.
- **Don't** repair the air conditioner by yourself as wrong maintenance may cause electric shock or fire or explode. Please contact an authorized service technician to conduct maintenance.
- **Don't** drop or fling the remote controller.
- **Don't** let any liquid in the remote controller.
- **Don't** expose the remote controller directly to the sunlight or excessive heat.
- **Don't** step on an unstable bench to operate or clean the unit. This may cause injury if you fall down.
- **Don't** operate the unit for more than 4 hours at high humidity (80% RH or more) and/or with windows or outside door left open.This may cause the water condensation in the air conditioner, which may drip down, wetting or damaging the furniture. The water condensation in the air conditioner may contribute to growth of fungi, such as mold.
- **Don't** charge or disassemble the batteries, and do not expose them to fire. This may cause the batteries to leak, or cause a fire or explosion.
- **Never** put batteries in your mouth for any reason to avoid accidental ingestion. Battery ingestion may cause choking and/or poisoning.
- **Never** press the button of the remote controller with a hard, pointed object. The remote controller may be damaged.

 **CAUTION** 

- **Ensure** the following objects are not under the indoor unit:
  - Microwaves, ovens and other hot objects.
  - Computers and other high electrostatic appliances.
  - Electrical sockets.
  - Items susceptible to water damage.
- **If** the remote controller does not function normally, remove the batteries for 30 seconds before reinstalling them.
- **If** reinstalling the batteries do not work, replace the batteries.
- **When** replacing the batteries, do not mix the new batteries with old ones or mix batteries of different types, which could cause failure of the remote controller.
- **If** the remote controller is not to be used for a long period of time, remove the batteries to prevent leakage that may damage the remote controller.
- **Properly** dispose the discarded batteries.

# Preparation before Operation

## Operating Range

- Operating the unit outside the recommended temperature range may have an impact on the system performance. When the temperature is too high, the air conditioner may trip the circuit breaker causing the air conditioner to shut down. When the temperature is too low, the outdoor heat exchanger may generate excessive moisture, leading to water dripping from the unit.
- In long-term cooling or dehumidification with a relative humidity of above 80%, doors and windows should be closed to prevent the indoor unit from generating too much water and causing leaks.

Range	Indoor	Outdoor
Cooling	16°C~32°C	16°C~46°C
		16°C~55°C (For tropical areas)
		-15°C~52°C (For low temp. cooling models)
Heating (Heat pump models only)	0°C~32°C	-15°C~24°C
		-25°C~24°C (For auxiliary heating models)

## Notes for Heating

- The fan of the indoor unit will not start immediately when the heating cycle has started. The unit will warm up and then start blowing air to avoid blowing out cool air.
- When it is cold and wet outside, the outdoor unit will develop frost over the heat exchanger which over time will cause the system to start the defrost function.
- During defrost, the air conditioner will stop heating for about 5-12 minutes.
- Vapor may come out from the outdoor unit during defrost. This is not a malfunction, but a result of fast defrost.
- Heating will resume after defrost is complete.

## Notes for Turning Off

- When the air conditioner is turned off, the main controller will automatically decide whether to stop immediately or after running for dozens of seconds with lower frequency and lower air speed.

## Important Notices

- This unit must be installed by a certified contractor to avoid:
  - Damage to the unit.
  - Refrigerant leaking in the atmosphere.
  - Electrical shock.
  - Burns from refrigerant.
  - Other serious injuries including death.
  - Leak test must be made after installation.
- To move and install air conditioner to another place, please contact our local authorized contractor.

## Emergency Operation

- If the remote controller is lost or broken, use force switch button to operate the air conditioner.
- If this button is pushed with the unit OFF, the air conditioner will operate in Mode: AUTO with a set temperature of 25°C and Fan speed: AUTO.
- If this button is pushed with the unit ON, the air conditioner will stop running.

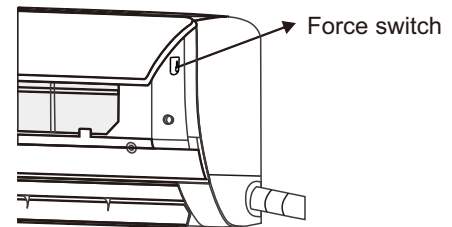

Only some models have force switches.

## Airflow Direction Adjustment

- Use up-down swing and left-right swing buttons on the remote controller to adjust the airflow direction. Refer to the operation manual of the remote controller for details.
- For models without left-right swing function, the air vent has to be adjusted manually.

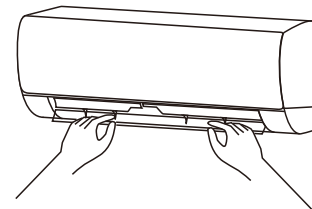

### Note:

**Adjust the air vents before the unit is in operation, or your finger might be injured. Never place your hand into the air inlet or outlet when the air conditioner is in operation.**

# Preparation before Operation

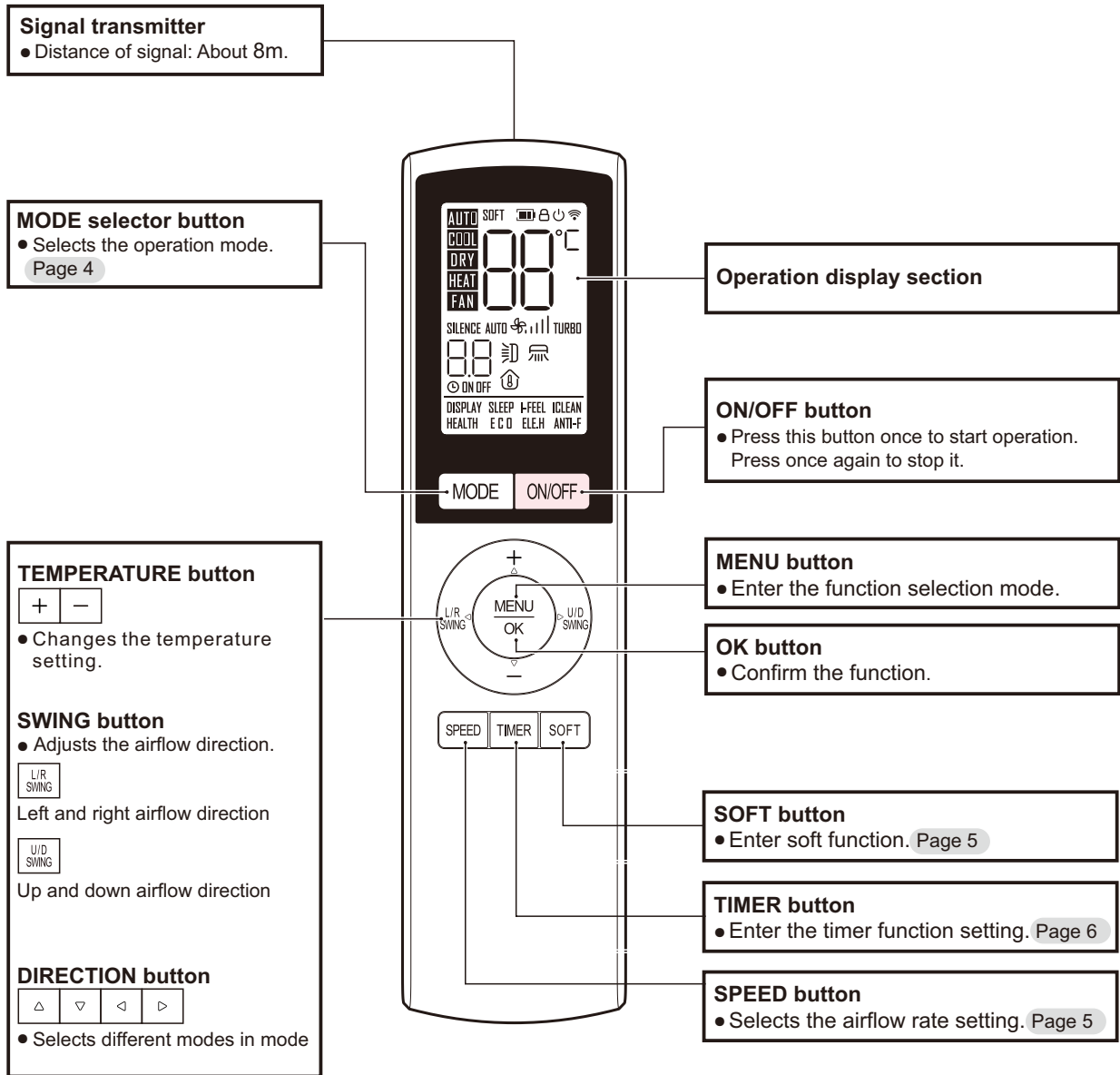

## ●Installing the remote controller batteries

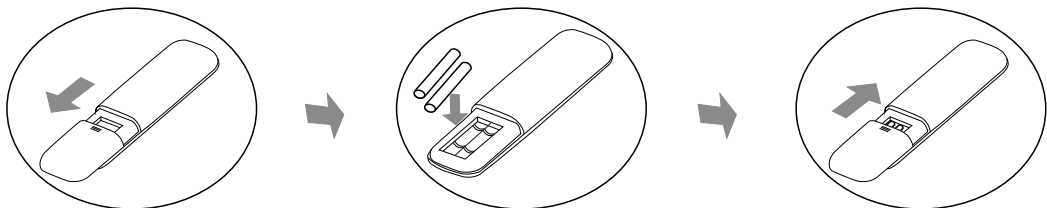

1. Slide to open the battery cover according to the direction indicated by the arrowhead.
2. Insert two brand new batteries (AAA), and position the batteries to the right electric poles (+ & -).
3. Put back the battery cover.

# Selecting Operation Modes

The air conditioner operates in the mode you choose.  
The next time you turn it on, it will operate in the same mode.

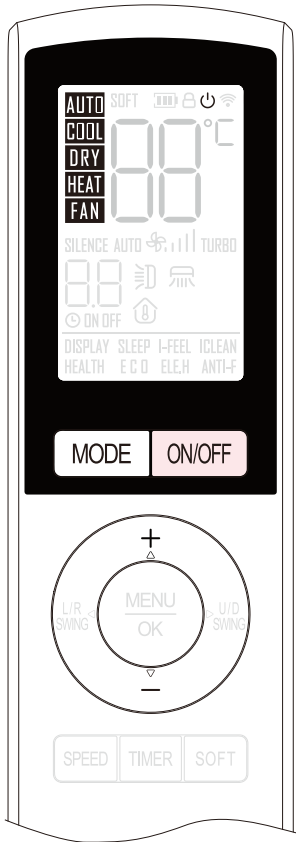

## Start Operation

1. Press **ON/OFF** to start the operation.

2. Press **MODE** to select operation mode.

Each press changes mode in the following order:



**Note: Heat mode is not available for single cool model.**  
Please read the Usage for Mode for a detailed description.



In AUTO operation, the system selects an appropriate operation mode (COOL or HEAT) based on the indoor temperature and starts the operation.

### AUTO

Mode: AUTO;  
Set temperature: 25°C;  
Fan speed: AUTO;

**Note: In the auto mode, the temperature setting is non-effective.**

### COOL

Enjoy cool air at your desired temperature.

### DRY

Reduces the humidity level in the space while maintaining the indoor temperature as much as possible.

**Note: In the dry mode, the speed setting is non-effective.**

### HEAT

Enjoy warm air at your desired temperature.

**Note: The cold wind type has no heating function.**

### FAN

Only the fan operates recirculating the air in the space

**Note: In the fan mode, the temperature setting is non-effective.**

3. Press **+** or **-** to set the temperature.

Each press raises or lowers the temperature by 1°C or 1°F.

The temperature setting range: 16°C~32°C.

**Note:**

The temperature can not be set in auto or fan mode.

Keeping the temperature setting at a moderate level helps save energy.

Recommended temperature setting:

For cooling: 26°C-28°C

For heating: 20°C-24°C

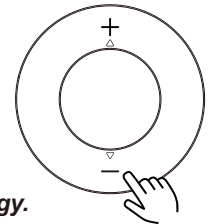

## Stop Operation

Press **ON/OFF** again to stop the operation.

The same setting is selected the next time by simply pressing.

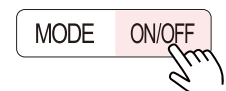

# Fan Speed and Airflow Direction Adjustment

When the air conditioner is on or the air conditioner is shutdown but the timer is on. You can adjust the airflow rate to increase your comfort.



## Fan Speed

Press **SPEED** to select fan speed.

Each press changes fan speed in the following order :



**Note:**

1. Auto is not available in fan mode.
2. Turbo is not available in auto mode.
3. The SPEED button is forced low speed in dry mode.

## Airflow Direction Adjustment

### 1. Left and right airflow direction

Press **L/R SWING** to activate horizontal airflow direction.

The left-right swing blade will begin to swing, and the screen will indicate or cancel "L/R SWING" icon.

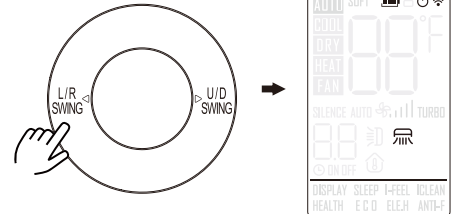

### 2. Up and down airflow direction

Press **U/D SWING** to activate airflow direction.

The horizontal vane will begin to swing, and the screen will indicate or cancel "U/D SWING" icon.

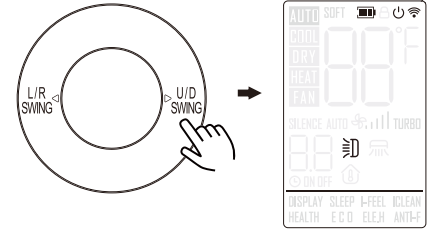

### 3. Rated swinging

Press **U/D SWING** and hold for 3 seconds, to activate rated swinging.

Each press changes airflow direction in the following order:

**Directional Airflow Control:**



Press **U/D SWING** again and hold for 3 seconds or reinstall the battery of the remote control could exit the "Rated swinging"

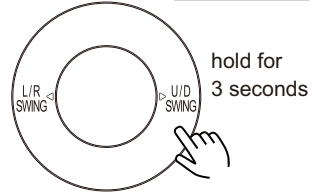

- (AUTO) The vane is set to the most efficient airflow direction.
- COOL/DRY: horizontal position.
- HEAT: position (5).

## Soft Operation

In the cooling mode, the unit blows air through up to 2430 Mico Vents preventing drafts while still cooling the space.

press **SOFT** to turn on or off the soft function, and the screen will indicate or cancel "SOFT" icon.

**Note:**

- a. The up/down swing or the rated swing will turn off.
- b. Press any of the "SOFT" button, "OFF", "U/D SWING" or switch mode will cancel the soft function.

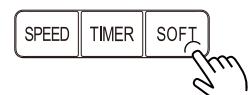

# ON/OFF TIMER Operation

Timer functions are useful for automatically switching the air conditioner on or off.

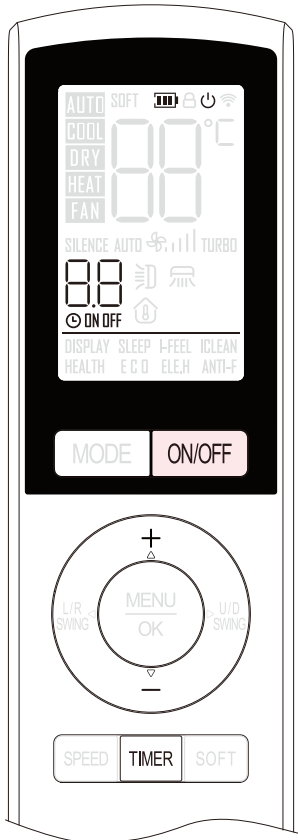

## ON TIMER Operation

When the unit is turned off.

1. Press **TIMER** will enter the timer function setting.  
Then “⌚” icon and “ON” character will light up, and “00” will be displayed and flashed in the screen.
2. Press the **+** or **-** buttons to set the number of hours in which the unit will be turned on.
3. Press **TIMER** again to confirm when the desired time is reached.

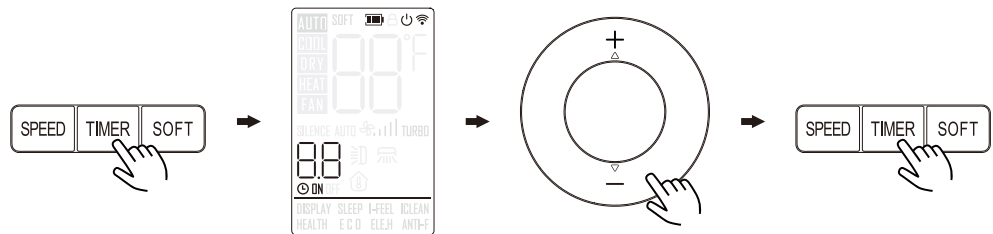

### Note:

**If the **TIMER** button is not pressed within 10 seconds after the “ON” start flashing, the timer setting will be exited.**

After the timer power on setting is confirmed, the “⌚” icon and “ON” character will stop flashing and remain lighting.

And the screen will display the corresponding mode, temperature, speed, swing, and all can be set by pressing the corresponding buttons.

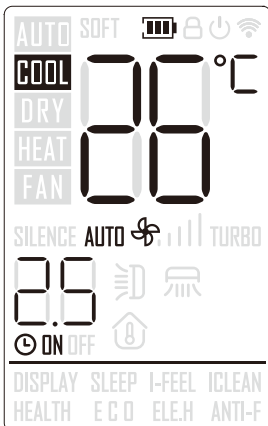

## Cancel ON TIMER Operation

1. After setting the timed power on, if the timer has not yet expired, press **ON/OFF** to directly turn on the unit and cancel the timed power on.
2. If timer setting is confirmed, press **TIMER** to cancel the timer function.

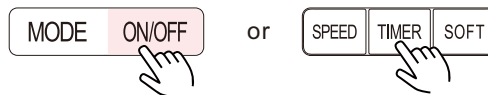

## OFF TIMER Operation

When the unit is turned on.

The operation method is the same as on timer.

## Cancel OFF TIMER Operation

The operation method is the same as cancel on timer.

# DISPLAY / SLEEP / I-FEEL / ICLEAN /HEALTH / ECO /ELE.H / ANTI-F Operation



## Mode Selection

1. Press to enter the function selection mode.
  2. Then press , , and button to choose the function which you want.
  3. After press button, turn on this function.
- In function selection mode, the character in LCD will be flashing when the function be selected.

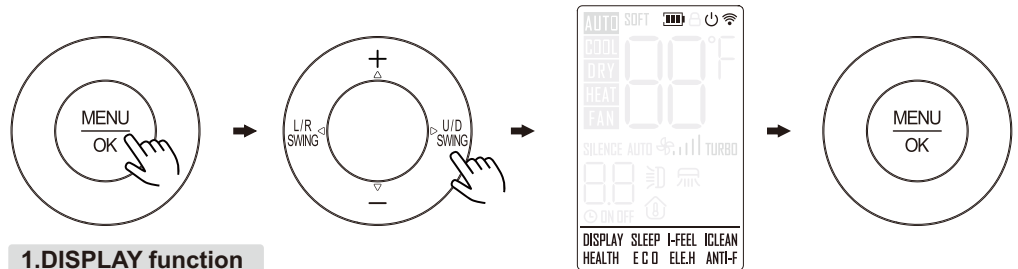

### 1.DISPLAY function

When the air conditioner is on, select this function.  
The air conditioning display screen will turn off or on.

### 2.SLEEP function

When the air conditioner is on, select this function to activate.  
After entering the sleep function, the air conditioner automatically adjusts the operating temperature and wind speed, and turns off the lights.  
The unit will exit function after 10 hours of continuous operation and restore to the previous status.  
**Note:** The sleep function cannot be activated in fan or auto mode.

### 3.I-FEEL function

When the air conditioner is on, select this function to activate.  
The air conditioner intelligently detects the temperature at the user's location and adjusts its operation accordingly. It first sets the average room temperature, then fine-tunes it based on the temperature around the user's position.

### 4.ICLEAN function

When the air conditioner is off, select this function to activate.  
The unit will automatically clean the dust on the evaporator and dry or blow-dry the moisture.  
The cleaning function will automatically shut off after 30 minutes.  
During the cleaning function, if the button is pressed, the unit will turn on immediately.

### 5.HEALTH function

When the air conditioner is on, select this function to activate.  
After activating the health function, the air conditioner will activate modules such as UVC to purify the air.  
**Note:** The health function will be automatically canceled when the air conditioner is turned off.  
This function is combined with the functions of air conditioning, and some products do not have this function.

### 6.ECO function

When the air conditioner is on and in the COOL mode, select this function to activate.  
The variable frequency air conditioner will enter the ECO function, which consumes the least electricity, and will automatically exit after 8 hours. The ECO function is not available on fixed frequency air conditioners. Changing modes or turning off the air conditioner will automatically cancel the ECO function.

**Note:** The electricity consumption is affected by the ambient temperature and the house structure etc., and when the ambient temperature is high or the house has a large area, be cautious to use the ECO function.

### 7.ELE.H function

When the air conditioner is on and in the HEAT mode, select this function to activate.  
The unit will activate the auxiliary heating function automatically according to the ambient temperature, so as to accelerate the heating.

**Note:** US models do not have this feature.

### 8.ANTI-F function

When the air conditioner and remote are off, select this function to activate. Upon activation, after each shutdown, the air conditioner automatically starts to operate for about 3 minutes to dry the moisture on the evaporator. This prevents the accumulation of bacteria, which can cause fungus, unpleasant odors, and potential health issues.

**Note:** If you need to turn off this function, you need to press the ANTI-F function again.



# Special Operation Functions

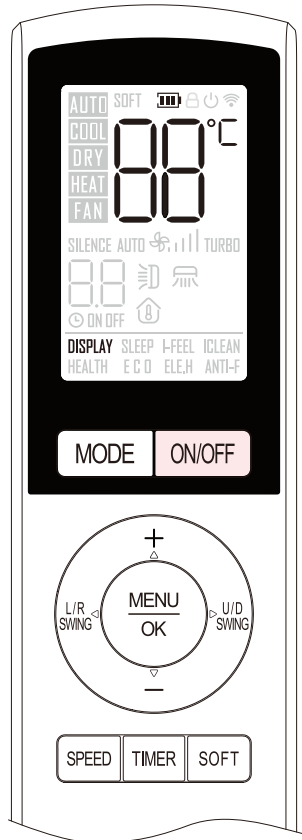

## Special Operation

### 1. °C/°F function

The default display unit for temperature is based on the actual product. Press the and buttons at the same time above 3 seconds, you can set the “°C” or “°F”.

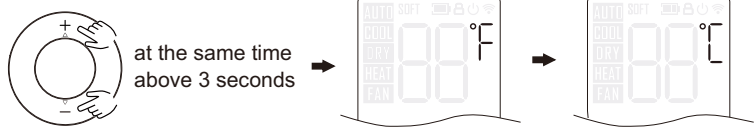

### 2. Child-lock function

Press the and buttons at the same time and hold for at least 3 seconds to activate or deactivate the child-lock function. Than other buttons cannot be used.

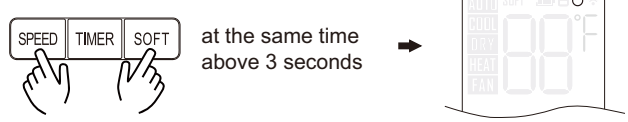

### 3. 8°C heating function

When the outdoor temperature is low (usually below zero degrees), this function will keep the indoor temperature within the range of 8°C to prevent indoor temperatures from dropping below zero degrees and freezing. Only in the heating mode and in the power-on state. Press the and buttons at the same time above 3 seconds to turn on or off the function. After turning on the function:

- a. Switch to mode, or select the sleep function, all can exit function.
- b. Press any of the , , button is non-effective.
- c. Turn off and on the unit again, 8°C heating function is still retained.
- d. Press the button, ELE.H function is not selectable.

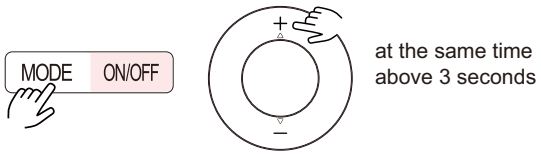

### 4. Buzzer silence function

Press the and buttons at the same time and hold for 3 seconds to activate or deactivate the buzzer silence function. After this function is enabled, the air conditioner buzzer is turned off, and the sound of the buzzer is no longer emitted when the air conditioner is controlled by the remote control.

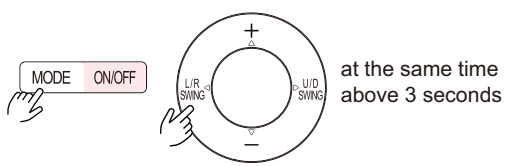

# Care and Cleaning

## ⚠ WARNING



- Do not expose electrical connections or electronics to moisture which can cause an electric shock.

## ⚠ WARNING



- Before cleaning the air conditioner, the unit must be shut down and the electricity must be cut off for more than 5 minutes, otherwise there might be the risk of electric shock.
- Volatile liquids such as thinner or gasoline will damage the air conditioner, therefore only clean the housing of air conditioner with soft dry cloth or a cloth that is slightly dampened with water.
- Make sure to check filters regularly to prevent the accumulation of dust which may affect the air conditioner performance. If the unit is installed in an environment that has more dust, the number of cleanings will need to increase. After removing the filter, do not touch the fin part of the indoor unit with your fingers as it may result in damage to the unit or injury.

### Clean the Panel

When the panel of the indoor unit is dirty, clean it with soft dry cloth or a cloth that is slightly dampened with water.

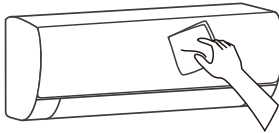

### Clean the Air Filter

#### ● Remove the air filter

1. Use both hands to open the front panel to gain access to the filters.
2. Gently release the air filter from the slot and remove.

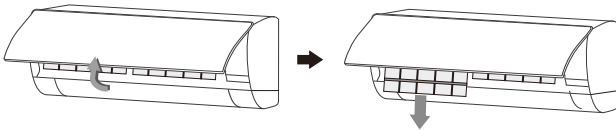

#### ● Clean the Air Filter

Use a vacuum cleaner or water to rinse the filter. If the filter is very dirty (for example, with greasy dirt), clean it with warm water (below 45 °C) with mild detergent. Put the filter in the shade to dry in the air.

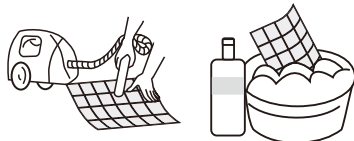

#### ● Clean or replacement the health filter screen

1. Cleaning: you can clean with the Air Filter;
2. Replacement: remove the filter from the filter frame and attach a new one.

#### Note:

**Do not throw away the filter frame.**

**Reuse the filter frame when replacing the health filter screen.**

**When attaching the filter, check that the filter is properly set in the tabs.**

**Dispose of the old filter as non-flammable waste.**

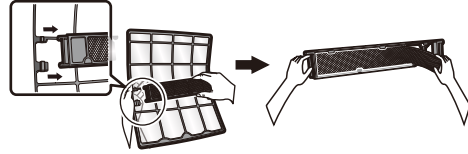

#### ● Mount the Filter

Reinstall the dried filter in reverse order of removal, then gently close the front cover and lock the panel.

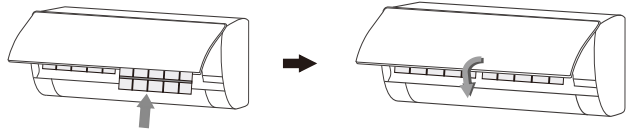

### Check before Using

- Make sure that all the air inlets and outlets of the units are unblocked.
  - Check whether the indoor unit drains properly.
  - Check the ground wire is securely grounded.
  - Check whether the remote-control batteries are installed and in proper operating condition.
  - Very that the outdoor unit is securely mounted and free from damage.
- If any issue exists, please contact our local contractor for inspection.

### Maintain after Using

1. Turn off the power source of the air conditioner at the outdoor unit.
  2. Clean the indoor unit panel and filter.
  3. Remove the dust and debris from the outdoor unit.
  4. Very that the outdoor unit is securely mounted and free from damage.
- If any issue exists, please contact our local contractor for inspection.

# Troubleshooting

## Ineffective operation

The air conditioner does not work.



- There might be power outages. → Wait until power is restored.
- Power plug may be loose out from the socket. → The plug in the plug tightly.
- Power switch fuse may blow. → Replace the fuse.
- The time for timing boot is yet to come. → Wait or cancel the timer settings.

The air conditioner can't run after the immediate start-up after it is shut down.



- If the air conditioner is turned on immediately after it is turned off, the protective delay switch will delay the operation for 3 to 5 minutes.

The air conditioner stops running after it starts up for a while.



- May have reached the setting temperature. → It is a normal function phenomenon.
- May be at a defrosting state. → It will automatically restore and run again after defrosting.
- Shutdown Timer may be set. → If you continue to use, please turn it on again.

The air blows out of the indoor unit, but the air is not being cooled or heated.



- Excessive accumulation of dust on filter, blocking the air inlet or outlet.  
→ Please clean the filter, remove the obstacles at the air inlet
- The louver blades are at an excessively angle limiting airflow.  
→ Please adjust the louvers to pointing straight.
- Poor cooling and heating effect caused by doors and windows opening, and unclosed exhaust fan. → Please close the doors, windows, the exhaust fan, etc.
- Auxiliary heating function is not turned on while heating, which may lead to poor heating effect. → Turn on the auxiliary heating function.  
(only for models with auxiliary heating function)
- Mode setting is incorrect, and the temperature and wind speed settings are improper.  
→ Please re-select the mode, and set the appropriate temperature and wind speed.

## Abnormal smell and sound

The indoor unit blows out odor.



- The air conditioner itself does not have undesirable odor.  
If there is odor, it may be due to accumulation of the odor in the environment.  
→ Clean the air filter or activate the cleaning function.

There is sound of running water during operation of the system.



- When the air conditioner is started up or stopped the system can make a "hissing" sound that might sound like running water.  
→ This is the sound of the flow of the refrigerant and not a malfunction.

A slight "click" sound is heard at the of start-up or shut-down.



- Due to temperature changes, panel and other parts will swell, causing the sound of friction.  
→ This is normal, not a fault.

The indoor unit makes abnormal sound.



- The sound of fan or compressor relay switched on or off.
- When the defrosting is started or stop running, it will create sound.  
→ That is due to the refrigerant flows to reverse direction. They are not malfunctions.
- Too much dust accumulation on the air filter of the indoor unit may result in fluctuation of the sound. → Clean the air filters in time.
- Too much air noise when "Strong wind" is turned on.  
→ This is normal, if feeling uncomfortable, please deactivate the "Strong wind" function.

## Abnormal moisture

There are water drops over the surface of the indoor unit.



- When ambient humidity is high, water drops will be accumulated around the air outlet or the panel, etc. → This is a normal physics phenomenon.
- Prolonged cooling run in open space produces water drops.  
→ Close the doors and windows.
- Too small opening angle of the louver blades may also result in water drops at the air inlet. → Increase the angle of the louver blades.

During the cooling operation, the indoor unit outlet sometimes will blow out mist.



- When the indoor temperature and humidity are high, it happens sometimes.  
→ This is because the indoor air is cooled rapidly. After it runs for some time, the indoor temperature and humidity will be reduced and the mist will disappear.

**Immediately stop all operations and cut off the power supply ,contact our Service center locally in following situations.**

- Hear any harsh sound or smell any awful odor during running.
- Abnormal heating of power cable and plug occurs.
- The unit or remote controller has been exposed to excessive amounts of water.
- Circuit breaker continuously trips.

## Troubleshooting

## Troubleshooting

## Troubleshooting

## DE-COMMISSIONING,DISMANTLING&DISPOSAL

This product contains refrigerant under pressure, rotating parts, and electrical connections which may be a danger & cause injur. All work must only be carried out by competent persons using suitable protective clothing and safety precautions.



Read the Manual



Risk of Electric Shock

**RoHS**



Unit is Remotely controlled  
& may start without warning



1. Isolate all sources of electrical supply to the unit including any control system supplies switched by the unit. Ensure that all points of electrical and gas isolation are secured in the OFF position. The supply cables and gas pipe work may then be disconnected and removed. For points of connection refer to unit installation instructions.
2. Remove all refrigerant from each system of the unit into a suitable container using a refrigerant reclaim or recovery unit. This refrigerant may then be reused, if appropriate, or returned to the manufacturer for disposal. Under no circumstances should refrigerant be vented to atmosphere. Where appropriate, drain the refrigerant oil from each system into a suitable container and dispose of according to local laws and regulations governing disposal of oily wastes.
3. Packaged units can generally be removed in one piece after disconnection as above. Any fixing down bolts should be removed and then unit lifted from position using the points provided and equipment of adequate lifting capacity. Reference must be made to the unit installation instructions for unit weight and correct methods of lifting. Note that any residual or spilt refrigerant oil should be mopped up and disposed of as described above.
4. After removal from position the unit parts may be disposed of according to local laws and regulations.
5. Meaning of crossed out wheeled dustbin: Do not dispose of electrical appliances as unsorted municipal waste, use separate collection facilities. Contact your local government for information regarding the collection systems available. If electrical appliances are disposed of in landfills or dumps, hazardous substances can leak into the groundwater and get into the food chain, damaging your health and well being. When replacing old appliances with new ones, the retailer is legally obligated to take back your old appliance for disposals at least free of charge.

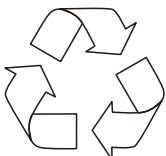

MADE IN CHINA

11326001001010